

Fri-Jado MCC Food Displays

Ambient - self-serve,
serve-over, on a base and
drop-in - 3-level



Table of contents

Features & Benefits	4
Self-serve models	
MCC Ambient 3-level self-serve on a base	5
MCC Ambient 3-level self-serve drop-in	7
Serve-over models	
MCC Ambient 3-level serve-over on a base	9
MCC Ambient 3-level serve-over drop-in	11
A taste of accessories	13

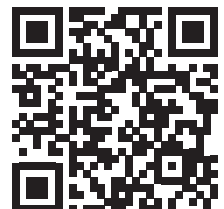

You name it, we can hold it

Elevate your food presentation

At Fri-Jado, **we are committed to making your food look and taste irresistible, helping you boost your sales.** By listening to our customers' specific needs, we've developed the MCC range of hot, cold and ambient displays for packaged and unpackaged food-to-go. The result? A solution tailored to meet all your requirements.

MCC Ambient

Our ambient display comes with 3-levels. Available in widths of 600, 900, or 1200 mm, self-serve or serve-over. On a base or as drop-in. Unlimited combination possibilities with other MCC and DC models, hot, cold or ambient.

Purchasing an ambient food display offers several advantages, particularly for businesses aiming to showcase non-refrigerated food items attractively and efficiently. Fri-Jado's MCC Ambient displays exemplify these benefits:

Outstanding presentation

Fri-Jado's ambient displays are designed for maximum transparency, ensuring your food items are visible from all sides. This 360-degree visibility enhances product appeal and can boost impulse purchases.

Space-saving design

Despite their compact footprint, these displays offer a large capacity, making them ideal for establishments with limited space.

Versatility and modular integration

The MCC range allows for seamless integration with hot and cold displays, all sharing the same design and dimensions. This modularity enables you to create a cohesive and flexible food display setup tailored to your specific needs.



Design

Transparent design	Up to 75% more food visibility* compared to other display solutions on the market. Seeing is buying! *According to global standards: TDA ISO 23953
Mirrored glass sliding doors on the operator side	Mirrored glass sliding doors enhance food visibility by creating a larger visual presentation area while saving space
Slim transparent shelves with adjustable height and angle	Gives you the opportunity to create a even more attractive, versatile, and customer-friendly display environment, leading to improved product visibility and potentially increased sales
Base in any RAL colour (standard RAL 9010), available in different widths	Designed as a standalone unit on a base, this food display saves valuable counter space while providing a sleek, integrated look. Available in 600, 900 and 1200 mm wide in 3-level
Drop-in model, available in different widths	Designed to be installed directly into countertops or serving surfaces, saving valuable counter space and providing a integrated look. Available in 600, 900 and 1200 mm wide in 3-level
Modular design matching with other MCC Hot, Cold and Ambient displays and with Fri-Jado's Hot and Cold Deli Counters	Create a complete line-up of hot, cold and/or ambient food displays in a uniform look and feel, to suit any food sales concept
LED lighting with natural colour reproduction on each shelf	LED lighting provides bright and even illumination across all shelves, making products more visible and attractive to your customers. LED has minimal heat emission, which helps in maintaining the optimal temperature within the display and preserving food quality

MCC Ambient self-serve on a base 3-level

Art. No.

MCC 60	MCC 90	MCC 120
9379112X	9379312X	9379512X

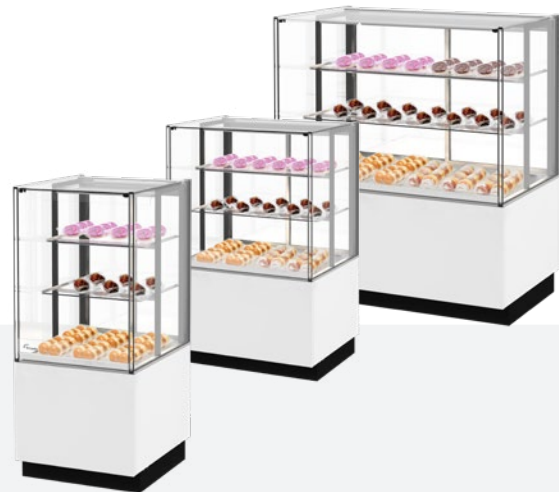

Dimensions & weight

	MCC 60	MCC 90	MCC 120
Width	600 mm	900 mm	1200 mm
Depth	750 mm	750 mm	750 mm
Height on stand	1420 mm	1420 mm	1420 mm
Net weight	125 kg	155 kg	185 kg
Gross weight	151 kg	187 kg	223 kg
Total presentation area	0.74 m ²	1.18 m ²	1.62 m ²

Power requirements & performance

Power	0.02 kW	0.04k W	0.05 kW
Voltage	1N~ 115-230 V	1N~ 115-230 V	1N~ 115-230 V
Frequency	50/60 Hz	50/60 Hz	50/60 Hz
Max. nominal current	0.1 A	0.2 A	0.2 A
Electrical connection*	2-pole earthed plug 16 A	2-pole earthed plug 16 A	2-pole earthed plug 16 A

* Length power cord appr. 1.5 m

MCC Ambient self-serve on a base 3-level

Art. No.

MCC 60	MCC 90	MCC 120
9379112X	9379312X	9379512X

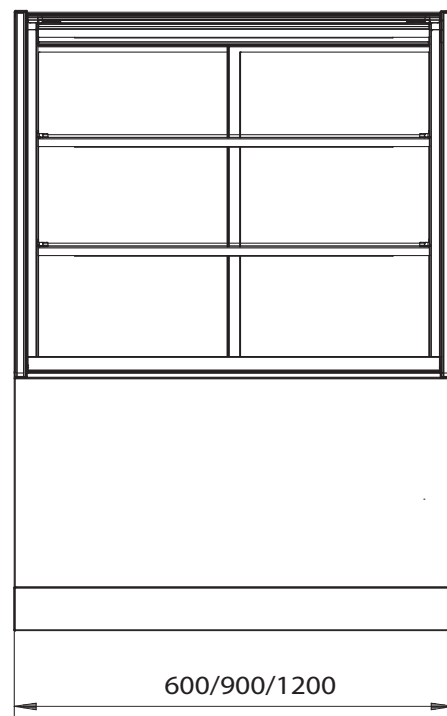
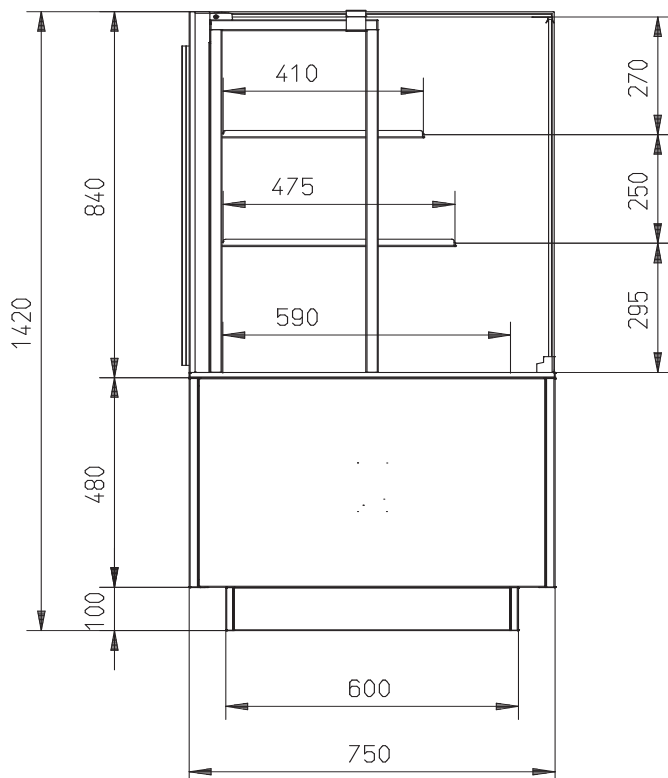

MCC Ambient self-serve drop-in 3-level

Art. No.

MCC 60	MCC 90	MCC 120
9379012	9379212	9379412



Dimensions & weight

	MCC 60	MCC 90	MCC 120
Width	600 mm	900 mm	1200 mm
Depth	750 mm	750 mm	750 mm
Height above worktop	840 mm	840 mm	840 mm
Net weight	125 kg	155 kg	185 kg
Gross weight	151 kg	187 kg	223 kg
Total presentation area	0.74 m ²	1.18 m ²	1.62 m ²

Power requirements & performance

Power	0.02 kW	0.04 kW	0.05 kW
Voltage	1N~ 115-230 V	1N~ 115-230 V	1N~ 115-230 V
Frequency	50/60 Hz	50/60 Hz	50/60 Hz
Max. nominal current	0.1 A	0.2 A	0.2 A
Electrical connection*	2-pole earthed plug 16 A	2-pole earthed plug 16 A	2-pole earthed plug 16 A

* Length power cord appr. 1.5 m

MCC Ambient self-serve drop-in 3-level

Art. No.

MCC 60	MCC 90	MCC 120
9379012	9379212	9379412

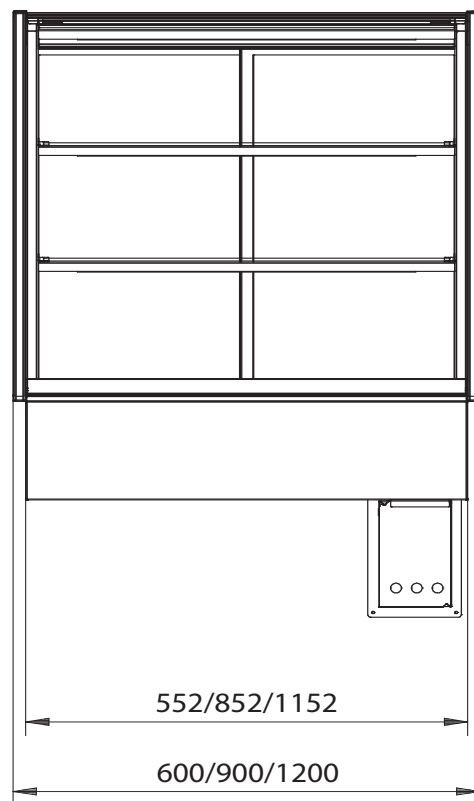
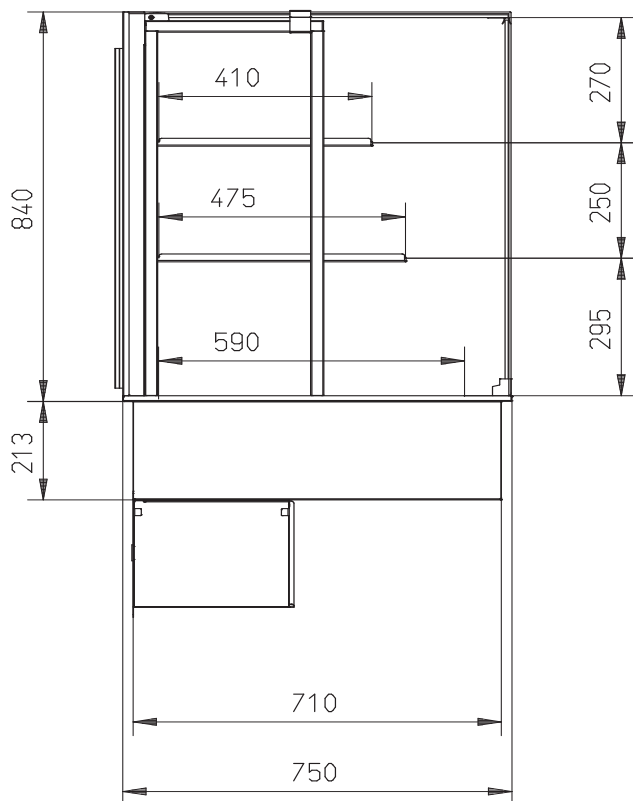

MCC Ambient serve-over on a base 3-level

Art. No.

MCC 60	MCC 90	MCC 120
9379111X	9379311X	9379511X



Dimensions & weight

	MCC 60	MCC 90	MCC 120
Width	600 mm	900 mm	1200 mm
Depth	750 mm	750 mm	750 mm
Height on stand	1420 mm	1420 mm	1420 mm
Net weight	125 kg	155 kg	185 kg
Gross weight	151 kg	187 kg	223 kg
Total presentation area	0.74 m ²	1.18 m ²	1.62 m ²

Power requirements & performance

Power	0.02 kW	0.04k W	0.05 kW
Voltage	1N~ 115-230 V	1N~ 115-230 V	1N~ 115-230 V
Frequency	50/60 Hz	50/60 Hz	50/60 Hz
Max. nominal current	0.1 A	0.2 A	0.2 A
Electrical connection*	2-pole earthed plug 16 A	2-pole earthed plug 16 A	2-pole earthed plug 16 A

* Length power cord appr. 1.5 m

MCC Ambient serve-over on a base 3-level

Art. No.

MCC 60	MCC 90	MCC 120
9379111X	9379311X	9379511X

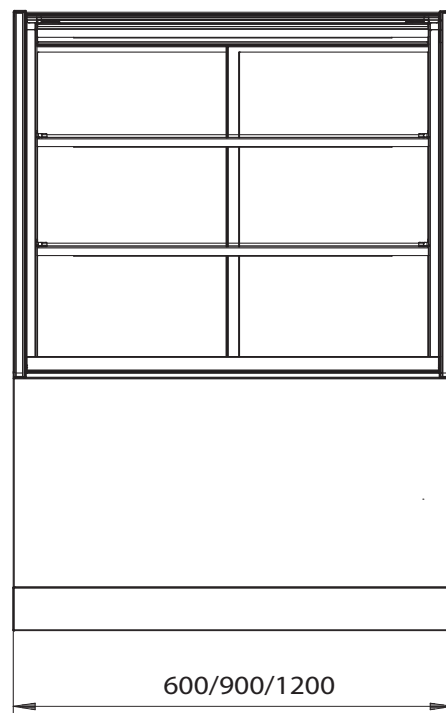
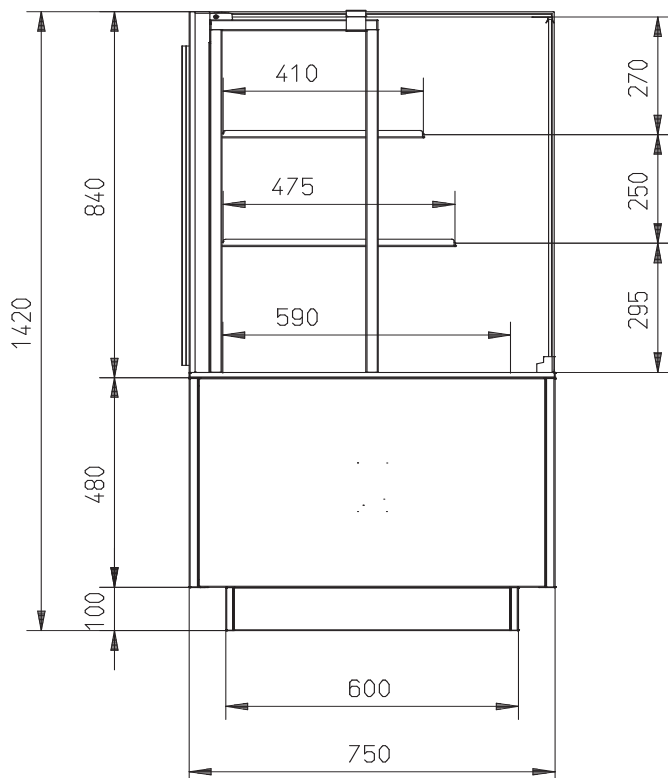

MCC Ambient serve-over drop-in 3-level

Art. No.

MCC 60	MCC 90	MCC 120
9379011	9379211	9379411



Dimensions & weight

	MCC 60	MCC 90	MCC 120
Width	600 mm	900 mm	1200 mm
Depth	750 mm	750 mm	750 mm
Height above worktop	840 mm	840 mm	840 mm
Net weight	125 kg	155 kg	185 kg
Gross weight	151 kg	187 kg	223 kg
Total presentation area	0.74 m ²	1.18 m ²	1.62 m ²

Power requirements & performance

Power	0.02 kW	0.04 kW	0.05 kW
Voltage	1N~ 115-230 V	1N~ 115-230 V	1N~ 115-230 V
Frequency	50/60 Hz	50/60 Hz	50/60 Hz
Max. nominal current	0.1 A	0.2 A	0.2 A
Electrical connection*	2-pole earthed plug 16 A	2-pole earthed plug 16 A	2-pole earthed plug 16 A

* Length power cord appr. 1.5 m

MCC Ambient serve-over drop-in 3-level

Art. No.

MCC 60	MCC 90	MCC 120
9379011	9379211	9379411

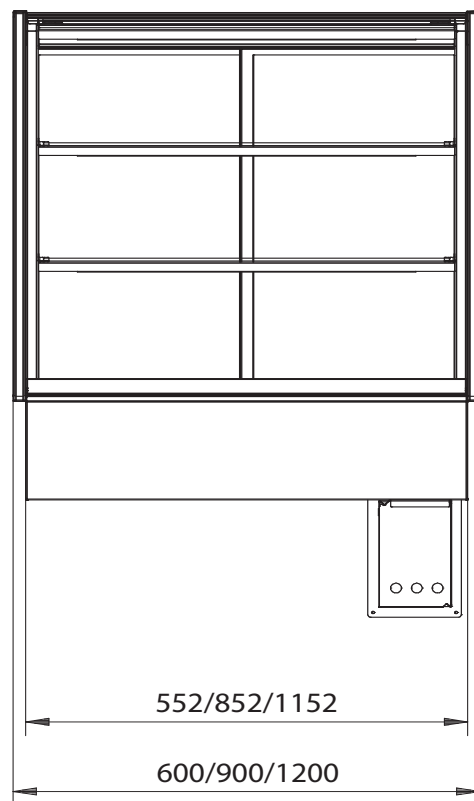
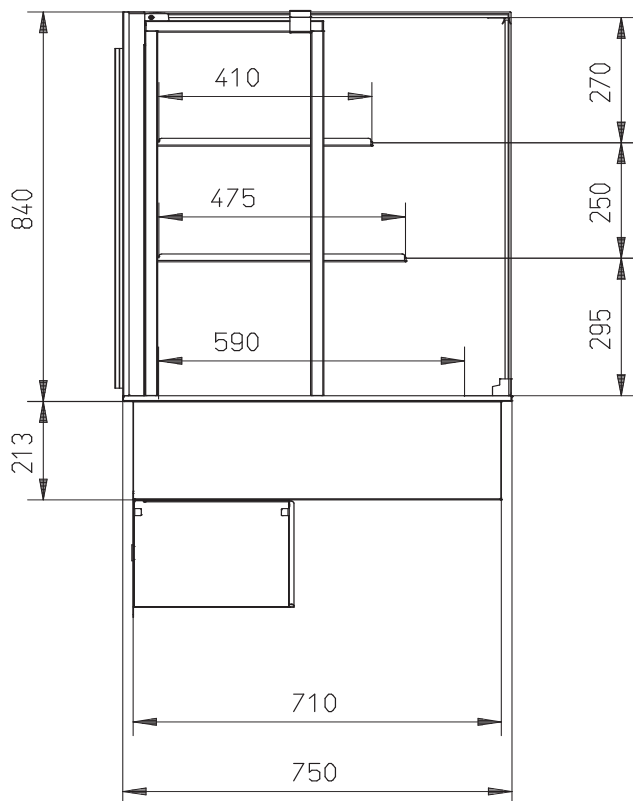

A taste of accessories

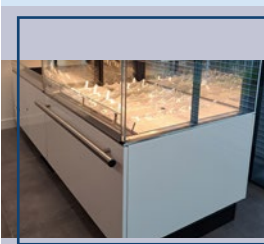

Bumper

To protect the display base against damage - not compatible with drop-in units



Castor set

For easy moving - not compatible with drop-in units



Fixing system for price rails

Ensure a secure presentation of your pricing with this dedicated fixing system for price rails

Accessories MCC Ambient	MCC 60	MCC 90	MCC 120
Description	Art. No.	Art. No.	Art. No.
Bumper	9380207	9380205	9380208
Castor set (height MCC + 23 mm)	9389852	9389852	9389852
Fixing system for price rails	9389811	9389812	9389813

Scan the QR code to view all accessories and corresponding article numbers

Discover all
accessories



Specifications and technical data are subject to amendment without prior notice.

This spec sheet contains basic drawings. For more detailed technical information, please visit www.frijado.com. The energy class declared here is based on standard product configurations, individual or customized units may differ. For more information please refer to the energy label provided with each cabinet or contact a Fri-Jado sales office. Whilst every care has been taken in the compilation of this spec sheet, and every attempt to present up-to-date and accurate information, we cannot guarantee that inaccuracies will not occur. Fri-Jado can not be held responsible for any loss, damage or inconvenience caused as a result of any inaccuracy or error on this spec sheet.



by **GSK** || Kältetechnik
Fachgroßhandel GmbH
info@gsk-diessen.de | www.gsk-diessen.de

www.frijado.com